

BAZETTA TOWNSHIP TRUSTEES EMERGENCY MEETING MINUTES

Date: October 15, 2020 @ 4:00 pm
Bazetta Township Administration Building
3372 State Route 5, N.E.
Cortland, Ohio 44410

Present:

Chairman Trustee Ted Webb - H
Vice Chairman Trustee Frank Parke - H
Trustee Bob McBride - H
Fiscal Officer Cynthia Chapman - A

Trustee Webb stated this meeting is being conducted via teleconference following the current guidelines defined by State of Ohio Open Meetings Law and in accordance under recommendations of legal counsel and Governor DeWine. There will be no public comments at the end of this meeting. This meeting is being audio recorded for informational purposes and will be posted on the website.

196-20 Resolution to approve the purchase of a 2021 Ford E 450 Medix MSV II Demo Ambulance M299 for \$149,463 from Penn Care Inc, 1317 North Road, Niles, Ohio 44446. The necessary expenditure incurred due to the public health emergency with respect to COVID-19. \$130,463 will be paid from Fund 2272-519 with remaining \$19,000 coming from the fire department budget. If any Cares Act Funds are unencumbered by November 15, 2020 those funds will be encumbered up to the \$19,000 back to the fire department budget for the purchase of the ambulance.

- a. Three quotes attached
- b. State Term Contract attached,

Note: cash price for ambulance \$154,263.00 with \$4,800 in savings.
See quote for details.

Motion: Trustee M
Second: Trustee P
Vote: Trustee McBride Y Trustee Parke Y Trustee Webb Y

197-20 To adjourn the meeting at 4:05 pm.

Motion: Trustee P
Second Trustee M
Vote: Trustee McBride Y Trustee Parke Y Trustee Webb Y

Attested by:

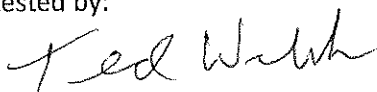

Approved by: Chairman Trustee Ted Webb

Date

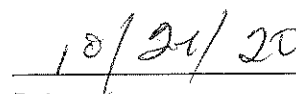

Date



Unit #:
XX-XXXX

DEALER: Penn Care, Inc
 CUSTOMER: Penn Care, Inc
 Street or P.O. Box _____
 City, State, Zip _____
 Customer Contact: _____
 Sales Associate: _____
 VIN#: MEDIX will assign VIN

Chassis Model Yr		2021
MEDIX Model		Type III-AD 170- MSV II
CHASSIS		Ford E-450 XL Cutaway, 7.3L Gas, 158" WB, 14,500 GVWR
BODY		170"L x 96"W x 72" Interior Headroom
QTY	STD/OPT	Description
1	16-M2-FG	Chassis & Conversion
01- Flooring & Interior Colors		
1	100040	Cabinets: Laminated Wood: Gloss Ggray Color:
1	STD	Upholstery: (Specify Color & compare to std. countertop color) Color: BLACK Brand: EVS
1	STD	EVS Cushions & Corner Padding
1	STD	Flooring: Lonseal- LonPlate (Diamond Plate) (Specify Color) Color: Gunpowder 424TX
02- Body & Chassis		
M-2 Standard Configuration		
1	STD	All Exterior compartments coated with a light gray rubberized urethan material.
1	STD	Anti-Theft Device: IdleLock Ignition Security System, PN: B-IDLE506-A for Ford E Series Chassis Only. Locate activation button to the right side of the steering wheel.
1	STD	Walk-Thru w/Sliding Door: Slides behind driver's seat, w/positive friction catch, and folding handle. Fluid dam at threshold.
1	DEL	DELETE STANDARD Compartment Lights: Optronics ILL36CB LED Compartment lights- ALL Models
1	99-0423	Lights: Compartment, TecNiq Flexible LEDs: 9", 27", 36" 45", 54", ILOS compartment lights. Locate: Compartment #1- (1) 44" E44-W010V-1 Locate: Compartment #2- (2) 27" E44-W06V-1 Locate: Compartment #3- (2) 44" E44-W010V-1 Locate: Compartment #4- (1) 36" E44-W08V-1 Locate: Compartment #6- (2) 54" E44-W012V-1 Locate: Compartment #7- (1) 9" E44-W02V-1 (if ordered)
		Locate: (1) Ceiling of Compt #1; (2) in Compt #2- (1) URH, (1) LLH; (1) in ceiling of Compartment #3; (2) in Compt #4/5; (1) in Compt #6.
1	STD	Compartment #1 SS Forward: Smooth Aluminum body, O2 Universal "M" or "H" cylinder storage for STEEL tank, Door w/gas strut hold-open, Sealed access to paddle handle in door panel. Stainless steel sill protector.
1	STD	Compartment #2 SS Center: Smooth Aluminum body, Open Storage, Double doors w/gas strut hold-opens. (1) Adjustable aluminum shelf w/DA finish. Sealed access to paddle handles in door panel. Stainless steel sill protector.

1	STD	Compartment #3 SS Rear: 3/4 Height, Smooth Aluminum body, Inside/Outside access, (1)- adjustable shelf w/DA finish. Door w/gas strut hold-open. Sealed access to paddle handle in door panel. Stainless steel sill protector.
1	200280a	Shelf: Adjustable, Smooth Aluminum w/DA finish, Exterior Compartment - MSVII ONLY Specify Location:
2	STD	Rear Entry Doors: Dual door system w/exterior/interior, locking paddle handles; fixed glass windows and Cast Grabber hold-opens. Sealed access to paddle handles in door panels. Stainless steel sill protector. Two-piece interior door panel.
1	STD	Compartment #4/5 CS Forward: NO body above floor, ALS Cabinet w/Inside/Outside access, Full height, single Door w/gas strut hold-open. Bottom section aluminum body with sealed access panel for single battery on roll out tray (or with optional roll-out battery tray for (2) batteries-See Electrical Section), latching door. Sealed access to paddle handle in door panel. Stainless steel sill protector.
1	STD	Curbside Entry Door: Single door system w/exterior/interior, locking paddle handles; window w/SLIDING glass; Gas strut hold-open. Sealed access to paddle handles in door panel. LED Step well light. Stainless steel sill protector. Two-piece interior door panel.
1	200320	Window: Sliding window in entry door ILOS Fixed Specify Location(s): side entry door
1	STD	Curbside Entry Door Stepwell: One-piece construction; (1) .125" smooth aluminum welded into door opening coated with rubberized urethane coating material. Stainless steel threshold trim. Dri-Dek insert on floor.
1	STD Modified	Compartment #6 CS Rear: Smooth Aluminum body, Vertical backboard storage w/(2) seat belts restraints (1) in upper Backboard section, (1) lower across Backboard and Stair Chair Section. Door w/gas strut hold-open. Sealed access to paddle handles in door panel, Stainless steel sill protector. INSIDE/OUTSIDE ACCESS to Compartment #6: With single 1/2" Acrylic hinged door w/round SouthCo latches. Opening to be located on wall facing squad bench - see option 99-0758 in cabinet section. This door faces the front of the truck.
1	STD	Divider: Aluminum w/DA finish, vertical in back Board Compartment Locate: Compartment #6
3	99-0250	Shelf: Adjustable, Smooth Aluminum w/lip, DA finish, Adjustable for Backboard Divider - MSVII ONLY Specify Location: Forward of divider in Compartment #6.
1	200200MSV	Power Door Locks: All Entry and Compartment Doors, wired to OEM door lock system. Includes (1) switch by Curbside Entry Door interior in standard 4-position switch panel and (1) at Rear Curbside Wall - MSV II ONLY
1	99-0678E	Power Door Locks: Stealth Switch, Power Door Lock System, Push Button Switch (Grille brackets: Ford 33-102402) LOCATION: Driver's side grille
1	STD	All Entry Door paddle handle and rotary latching components will include emergency door releases located top and bottom of each door and shall meet the FMVSS 206 30G Test Requirement
1	200277	Running Boards: "Starburst" Grip Punched, Chevy/GMC, Ford, Sprinter Type III
1	STD	Fender Flares: Stainless Steel
1	STD Modified	Rear Bumper: Cast aluminum corner pods w/Dock bumper pads, Center grip-strut flip-up step, powder coated steel frame
1	99-0390	Rear Bumper Pods, Cast Aluminum w/Medix Logo- ILOS ADP Pods - MSVII ONLY

2	STD	IV Hangers: (2) Cast black rubber fold-down over knee area of Cot and Squad Bench
3	STD	Mirrors, OEM: (1) each cab door, (1) on interior windshield
4	STD	Wheel Covers: Stainless steel covers w/Valve Extenders
4	STD	Stone Guards: Lower body corners, ADP
1	STD	Kick Plate, Rear: ADP, below rear doors across to corner posts
1	STD	Rub Rails: C-Channel, tapered ends, Lower Body off-set mount with neoprene spacers.
1	STD	Fuel Fill Bezel: Cast aluminum
1	STD	Fuel Fill Scuff Plate: Stainless steel, below fuel fill bezel
1	STD	Insulation: Pink, double sided radiant barrier/acoustic material, installed on curbside and streetside rear wheel wells.
1	STD	Insulation: Spray in place foam, FR 2-Part Spray Foam, CP-1000 Kit 200, applied to curbside entry step well and both rear wheel wells
1	STD	Undercoating: Per Ford QVM Guidelines
	03-	Brake, Turn & Back-Up Lights
1	STD	Lights: DOT, Brake/Tail, Turn, Back Up: Whelen 600 Series LED.
1	STD	DOT Marker Lights: TecNiq LED, rubber grommet bezels; (7) S34-AC09-1 Amber- (5) on front of body as Marker lights, (2) side facing on rear extrusions as Turn Signals; (7) S34-RC90-1 Red- (5) on rear of Body as Marker lights, (2) side facing as Turn Signals.
	04-	Electrical, Power Distribution, Control Center & Interior Lighting
1	STD	Battery Switch, Automatic: TST CDR-400- Located in Electrical Cabinet.
2	STD	Batteries: OEM, 650 C.C.A.
		Locate: (1) Under hood, (1) In roll-out tray in Compartment #4/5
0	99-0549	Battery: (1) Additional, OEM with dual roll-out tray, cables, studs, connectors and 3rd OEM 750 C.C.A. battery for Type 2
1	99-0076	12VDC: 12 gauge power & ground, IATS Specify Location(s): Front Console
1	STD	(1) Camera System: RVS Systems - RVS-MV3-IR - Kit. Includes (1) 7" rear view mirror monitor, (1) flush mount MV1 back-up camera and (1) RVS-826 camera cable. Locate: (1) Camera mounted off lower RH corner of center rear Amber light; Monitor mounted on cab windshield rear view mirror.
1	STD	Front Console/ Switch Panel: CNC cut, formed, welded and powder coated aluminum attached to floor. PNs: 44-A1-1907 / 44-A1-2339 Switch and siren panels removable for ease of access. Switch panel: Engraved black plastic with (12) LED lighted switches for Emergency Master, Primary/Secondary Modes, Light Bar, Siren/Horn, Left, Rear and Right Floods, Back-Up Alarm, Module Disconnect. Siren mounted in engraved panel below switches.
2	DEL	DELETE STANDARD Antenna, Radio Coax Cables - they are replaced with option below for cables and antenna bases already attached.
2	99-0747	Antenna: Install (2) 25' Radio Coax Cable with 3/8" through-hole base hardware ILOS (2) Radio Coax without bases. Order P/N# BMATM-NC-25. Cut holes in roof and install bases with caps. Install Standard Power/Ground for each behind driver's seat. Run coax to std. locations above dome #1 and #2, terminate behind driver's seat.
8	STD	Dome Light: Whelen LED, 18-diodes w/chrome flange MX80EHZA , switched separately with Hi/Lo functions- ILOS

3	99-0525	Lights: Dome, Whelen 9-diode, 80CBEHCR, (6) White, (3) Blue LEDs w/chrome flange- ILOS. Modify switching for Center lights; (6) White on Hi-side, (3) Blue on Lo-side. Switch labeled "White" at top; "Blue" at bottom. MSV II
1	STD	Action Area Light: Whelen PSC0ADCR, 12 VDC LED Strip light, 6 diodes and On/Off switch on rear control panel
1	STD	USB Port: Vanner VSS-USB dual port 2Amp mounted on A/A wall
1	99-0617	Shoreline: 125 VAC, 20-Amp, Kussmaul SUPER Auto Eject ILOS. Kussmaul P/N: 091-55-20-120 side wired w/hinged,yellow, weatherproof cover, Located above Compartment #2 on Streetside. Will have to be mounted on the Kussmaul Stainless Steel E-Z mounting plate w/indicator light for access. Kussmaul P/N: 091-185-009. Mating Connector to be shipped loose.
2	STD	Switch, Momentary Disable: For Scene/Load Lights. (1) Located on Curbside Wall in 4-position plastic bezel: MX01507. (1) Located on Rear Curbside wall in standardized position, no bezel required, vertical S.S. trim is punched for switch.
1	STD	Timer: 5-minute check-out, wired to CS High mode dome lights
1	99-0550	Switch, Momentary, 15-Minute Timer for Dome Lights. Located in standard 4-position Positron switch panel in standardized position on Curbside Wall. (PNs:MX09150 switch, MX09151 Timer).
1	400160	Inverter: Vanner 20-1050CUL- 1000watt w/battery charger and built in GFI. Remote controlled w/switch in rear panel. (This option deletes the GFI in the A/A wall). ILOS NOTE: OPTION 99-1955 IS REQUIRED WHEN ANY INVERTER IS MOUNTED IN ANYBULKHEAD or INTERIOR INCLOSED CABINET. Location: Must specify location.
1	400150	Battery Charger: DELETE STANDARD (when adding Inverter with integral charger)
1	STD	Breaker Box: 125 VAC w/20-Amp Breaker located behind the driver's seat base. GFI receptacle located on the Action Area wall.
3	STD	12 VDC Outlets: (1) in Action Area, (1) in ALS Cabinet, (1) in 2nd Action Area
3	STD	125 VAC Outlets: Duplex, located (1) in Action Area, (1) in ALS, (1) in 2nd Action Area
1	STD	Rear Switch Panel: Engraved black plastic panel with (14) LED lighted switch positions for Dome Lights (Streetside, Center, Curbside), Vacuum, Vent, A.A. Light, Inverter, Spare switches and digital clock w/Mode Buttons. MX01517.
8	99-0661	Lighting, Accent: TecNiq D04-B001-1 Dragon Light Vertical, Blue LED w/WHITE case (D04-0WV0-1), 36" wire. Will have Rocker On/Off Switch in Rear Panel, labeled "CABINET LIGHTS" (MX09122) - operates all at same time. Price per light. Locate: Just inside front top corner of each cabinet. NOT ON BACK WALL. RUN WIRES FROM ENTRY ON BACK WALL (at sides, not center of back wall) AND KEEP UP HIGH IN TOP EDGE, EACH SIDE. Locate: (2) in Upper rear main, (2) in Action Area overhead, (2) in Rear Overhead and (1) per each Squad Bench Overhead section in corner closest to the rear doors.
05- Warning Lights & Sirens		
1	STD	Lights; Warning, Whelen LED EMERGENCY Lighting Package- Ford, Chevy Type I and Type III- MSV-II Models ONLY. NOTE: Does not include LED Scene or Load Lights.
		All LED lights shall have CLEAR Lenses. All emergency and scene lighting shall have chrome flanges in standard locations.
		Front of Body: Add (7) 9x7 Whelen LEDs- Specify pattern by LED Color (6) Red, (1) White: R-R-R-W-R-R-R. Outer (2) lights and (1) Center light flash on K-Spec flasher. Inner (4) flash independently on Light Bar switch on front console.

		Sides of Body: (4) Whelen 900 Series Red Super-LEDs: (2) each side in upper corners
		Rear of Body: (4) Whelen 900 Series Red Super-LEDs: (2) in upper outboard corners, (2) Mid-Body wired as Warning/Brake at the window level; (1) Whelen 900 Series Amber Super-LED in the center position over the rear doors.
		Brake, Turn & Back-Up Lights: Whelen 600 Series LEDs
		Lights, Warning, Intersection Lights: (2) Whelen 700 Series Red Super-LEDs on Front Fenders; (2) Whelen C7LRC Series Red Super-LEDs above rear Wheel Wells- wired to Pri/Sec Modes
2	STD	Lights, Warning, Grille: LINZ6R Red LED w/clear lenses & chrome flanges on center grille bar
6	500127	Lights: Scene/Load, Whelen 900 Series Super-LED 9SC0ENZR Gradient Opti-Scenelight™ with flange included- ILOS Halogen Specify Locations: (2) on each side; (2) on rear
1	STD	Flasher: Dual mode flasher for Warning Light system, Vanner 9860GCPE
2	STD	Siren Speakers: dual 100 Watt drivers mounted through the front bumper
1	STD	Siren- Whelen 295 SL5A1, 200 Watt
1	99-0277	Lights: Warning, Door Open, (Qty. 3 for all entry doors): Whelen 2" T0A00FAR 5mm LED Amber w/TGROM2 rubber grommet Locate: (1) on each lower outboard corner of open rear doors; (1) on lower outboard corner of open Curbside Entry door. All three located above the kickplates. Light to flash when door is open.
06- Oxygen, Vacuum & Miscellaneous Items		
3	STD	Oxygen Outlets: Quick-connect style, 2-in Action Area, 1-over Squad Bench
1	600100	Oxygen Outlet, OHMEDA Z-QD0101M0 Green Face Plate, IATS Locate: In standard position in ceiling
1	STD	Electric Oxygen with manual bypass and switch on A/A panel
1	STD Modified	Suction Aspirator System: SSCOR disposable container mounted on Action Area panel w/SSCOR gauge and quick-connect; GAST vacuum pump mounted on ceiling of Compartment #2.
1	STD	Oxygen Cylinder Retention: Universal for "M" or "H" cylinder, steel w/3-spring buckle straps and top collar, powder-coated Safety Yellow color- in Compartment #1.
1	STD	O2 Regulator: Amvex, 50psi, pre-set
07- AC / Heat		
1	STD	HVAC System: High capacity ProAir, brushless free blow combination Heat-AC system with digital thermostat control on the action area wall. HVAC unit mounted in front bulkhead above the walk-through.
08- Cabinets, Hardware & Miscellaneous Items		
1	STD	Main Streetside Wall Cabinets: Specify required configuration-
1	OPT	Cabinet Configuration- CPR Seat w/EVS V-4 seat belt system and 2nd Action Area; includes (1) 125VAC and (1) 12VDC outlet in 2nd Action Area
		Main Wall aisle-facing Cabinets will have (1) adjustable laminated wood shelf in each and sliding Lexan doors with full height extruded handles. DELETE STANDARD Recessed cabinet for suction aspirator container. Stainless steel trim on lower face. See Prints for Configuration.

1	99-0939	Main Wall: Reconfigure Streetside Cabinet Wall to delete the standard (2) angled cabinets on either side of CPR Seat. 2nd Action Area to be 22" W x 21.875" H, this will cause the 2nd A/A to protrude into compt. #3 (special tub). Upper rear cabinet face to be flush with Lower Main. The CPR seat will be widened to 32" shifting forward and eliminating the recessed suction. Includes Engineering time.
1	99-1077	Mounting Plate: 0.25"x15"x 15" mounting plate PN: 33-101886 installed beneath the 2nd action area countertop for future installation of customer supplied monitor mount.
2	99-0540	Main Wall Cabinets: Restocking Feature, Interior Cabinet, Under 40" Width- Sliding Plex door w/hinged, keyed frame w/(2) Titan 15-pound gas struts and (2) spring-loaded elbow catches. Locate: (1) Action area overhead cabinet; (1) upper rear cabinet
1	STD Modified	Action Area Overhead Cabinet: Full-height and depth aisle-facing cabinet w/sliding Lexan doors and full height extruded handles. Cabinet to extend full width of 1st Action Area.
1	STD	Action Area and Switch Panel: Laminated, sealed countertop and vertical panel with Suction system collection canister, Vacuum gauge, (2) Oxygen outlets, (1) USB, (1) 12VDC Outlet, (1) 125VAC Outlet and digital Thermostat. Switch panel MX01517 includes (10) switch positions and digital clock w/Mode Buttons.
1	STD	Corian Countertop - 1st / 2nd Action Area, Color: Gray Mist HL-027 w/Eclipse HL-039 Top and perimeter accent lips. To extend over the edge of cabinet main
1	DEL	DELETE STANDARD Cabinet overhead, forward of CPR Seat: Beveled cabinet w/(1) adjustable shelf and (2) hinged 1/2" Acrylic doors w/(2) round SouthCo latches on bevel side.
1	STD Modified	CPR Seat, 2nd Action Area: Wider 32"W CPR seat w/hinged, latching lid, storage under seat w/TriMark latch, formed back rest and seat cushion; 2nd Action Area w/(1) 12VDC outlet, (1) 125VAC outlet
1	DEL	DELETE STANDARD Cabinet overhead, rear of CPR Seat: Beveled cabinet w/(1) adjustable shelf and (2) hinged 1/2" Acrylic doors w/(2) round SouthCo latches on bevel side.
1	STD	Sharps/Waste Tilt-Out Cabinet: Below 2nd Action Area with LOCKING Austin LifeDefender latch. Note: See option below for lock.
1	DEL	Inside/Outside access to Compartment #3: With dual 1/2" Acrylic hinged doors with non-locking, two point Eberhard pinch latches
1	99-1058	Seating: EVS Technician's Seat w/Child Restraint System, Rear facing automotive style chair with 4Pt seat belt mounted on Standard SWIVEL Base- ILOS 4Pt seat.
1	STD	Seat Base: EVS SB-2 Swivel Base for EVS Technician's Seat
2	STD Modified	Front Bulkhead Wall Cabinets: Electrical Cabinet located above Tech Seat w/round SouthCo LOCKING latching, vented door; HVAC cabinet and filtered air return above Walk-Thru. Note: See option below for lock.
1	STD	Bulkhead Cabinets: Upper cabinet- general storage w/hinged, Austin LifeDefender LOCKING door; Lower cabinet general storage w/hinged, LifeDefender LOCKING vented door. Note: See option below for lock.
3	99-1839	Lock: Austin CW-LOCKASSY-545 tumbler lock to work with Austin Defender cabinet door or drawer latch. Locate: Bulkhead cabinets D & E; sharps/waste tilt-out
4	800230	SouthCo Latches, Round, Metal Locking - ILOS Each. Locate: (4) ALS acrylic doors per below.

1	STD Modified	Cabinet Above ALS: Open storage w/dual 1/2" Acrylic doors w/ LOCKING SouthCo round latches at top of doors, non-locking at bottom, (1) adjustable shelf.
1	STD Modified	ALS Cabinet: Lower Section- Locking storage for box or bags w/LonPlate flooring; Middle Section- 6-inch deep drawer w/locking latch and gas strut closure w/Dri-Dek mat; Upper Section- w/ dual 1/2" Acrylic doors w/round LOCKING SouthCo latches at top of doors and non-locking at bottom and (1) adjustable shelf w/ LonPlate flooring.
1	STD	Glove Box Holders: (3) w/hinged, powder-coated steel door, in pad above Curbside Entry Door
1	99-0546	Cargo Net: Head of Squad Bench- Type I / III (166, RP-90, MSV II) PN: 86-101723, bolted to taping plate in the floor, wall and ceiling. PN: ZRS-NETMEX009-02-A.
1	STD	Squad Bench:
	1	Full length hinged lid w/TriMark latch for access to interior storage
	2	Full length upholstered seat cushion except over Sharps/Waste Area; formed upholstered back rest cushions and head pad for each seated position.
	3	(2) EVS V-4 Belted seating positions w/progressive foam back and head pads and (3) short bottom straps for 2nd Patient restraint
	4	Stainless steel trim on lower face.
1	STD	Sharps/Waste: Drop-in style w/Red polycarbonate hinged lid with standard containers, located at head of squad bench.
1	STD	Cabinet, Squad Bench Overhead: with (2) flip-up 1/2" Acrylic doors and Eberhard two point squeeze latches.
1	99-1011	Cabinet: Squad Bench Overhead, Cabinets to have Austin constant torque hinges installed, ILOS stainless steel hinges.
1	99-0758	Inside/Outside Access to Compartment #6 from squad bench side (over foot end of bench): With single 1/2" Acrylic hinged door w/(2) round SouthCo latches, hinge on Left side of door- for MSV II only - AT FOOT END OF BENCH - faces front of truck.
1	STD	Cabinet, Rear Overhead: Cabinet over rear door opening with (1) flip-up 1/2" Acrylic door and (2) round SouthCo latches.
1	99-0613	Assist Rail: 72" Powder Coated Safety Yellow SS 1.25" w/Radius Ends, ILOS -All Models
1	99-0615	Assist Rail: 72" Powder Coated Safety Yellow SS 1.25" w/Radius Ends, IATS -All Models
1	99-0683	Grab Handles: (3) 12", Powder Coated Safety Yellow 1.25: SS w/Radius Ends- ILOS -All Models
1	99-0745	Grab Handle: (1) 18", Powder Coated Safety Yellow, 1.25" SS w/Radius Ends PN: G304-49101356PCBY, IATS Location: Curbside rear inside rear doors on Compartment #6 interior cabinet wall. See Print. Matches the entry door grab handle style.
3	STD	Reflective Striping- Alternate Red/White chevron pattern on smooth aluminum kick panel- mounted on each rear entry and curbside entry door
9	STD	Reflective Striping, Door Open Protection: .50" Red reflective striping around interior door pan of all body doors.
09- Cots & Miscellaneous Items		
1	99-0726	Cot Mount: Stryker Power/Performance Load Floor mount "Plate Only", ME-153, ME-166, MSV-II 157 and 170 models only. NOTE: Center, need charging wire as well
10- Paint & Lettering		
1	STD	Paint: Body all OEM White

0	1000100	Roof Star ONLY, INSTALLED
		SHIP LOOSE
2	STD	Fire Extinguisher: (2) 5 lb- Ship Loose is Standard
TOTAL ORDER		

I have reviewed this Order and find it to be acceptable and ready to build.

_____ **Date:** _____
 Dealer Signature

I have reviewed this Order and find it to be acceptable and ready to build with the addition of the attached, approved changes.

_____ **Date:** _____
 Dealer Signature

Due to on-going product improvements and the changing requirements of the ambulance industry, MEDIX Specialty Vehicles, Inc. reserves the right to change product specifications and related products without prior notice and without any obligation to change prior products or parts. ALL PATENTS RIGHTS RESERVED.

Invoice

Estimate

Spartan Armor Systems



Address
1830 W Copper St
Tucson, AZ 85745
Phone: (520) 396-3335
Email: info@spartanarmorsystems.com

Order #	Date
S10004	07/28/2020



Bill To:
Bazetta Township Fire Department Chief Dennis Lewis 3000 Warren Meadville Road Cortland, OH 44410

Ship To:
Bazetta Township Fire Department Chief Dennis Lewis 3000 Warren Meadville Road Cortland, OH 44410

Customer: Bazetta Township Fire Department

Contact: Bazetta Township Fire Departme

Memos

Date	User	Memo

Sales Rep	Payment Terms	FOB Point	Carrier	Ship Service	Date Scheduled
wburtness	Net 30	Origin	USPS1		07/28/2020

Item #	Type	Number / Description	Unit Price	Qty Ordered	Total Price
1	Kit	SAS-AR550PKG-LEGION-FC-BK-KIT - Spartan Armor Systems Level III+ AR550 and Sentinel Legion XL Plate Carrier Package - Black	\$509.24	3 ea	\$ 1,527.72
2	Sale	SAS-5501114-SGL-FC - AR550 Armor 11x14 Single Plate - Full Coat	\$0.00	6 ea	\$ 0.00
3	Sale	SAS-LEGION-BK - Spartan Armor Systems Legion XL Plate Carrier - BK	\$0.00	3 ea	\$ 0.00
4	Kit	SAS-PKG550-STNL-BK-FC-KIT - SPARTAN ARMOR SYSTEM SENTINEL AR550 PLATE CARRIER PACKAGE	\$459.24	3 ea	\$ 1,377.72
5	Sale	SAS-5501012-SGL-FC - AR550 Armor 10x12 Single Plate - Full Coat	\$0.00	6 ea	\$ 0.00
6	Sale	SAS-STNL-BK - Spartan Armor Systems Sentinel Plate Carrier Black	\$0.00	3 ea	\$ 0.00
7	Kit	SAS-55066-FC - AR550 Armor 6x6 Side Plates Set of Two - Full Coat	\$0.00	6 ea	\$ 0.00
8	Sale	SAS-AR55066-SGL-FC - AR550 6x6 Side Plate Single - Full Coat	\$0.00	12 ea	\$ 0.00
9	Sale	FIRE-BK-RED-73 - FIRE PATCH BLACK BACKING RED FONT 7 x 3	\$0.00	6 ea	\$ 0.00
10	Sale	FIRE-BK-RED-4.51.5 - FIRE PATCH BLACK BACKING RED FONT 4.5 x 1.5	\$0.00	6 ea	\$ 0.00
11	Subtotal	Subtotal			\$ 2,905.44
12	Discount	Law Enforcement Discount			-\$ 435.82
13	Subtotal	Subtotal			\$ 2,469.62

Invoice

Estimate



Spartan Armor Systems

Address

1830 W Copper St

Tucson, AZ 85745

Phone: (520) 396-3335

Email: info@spartanarmorsystems.com

Order #	Date
S10004	07/28/2020



Subtotal:	\$2,469.62
Sales Tax:	\$0.00
Total:	\$2,469.62
Paid:	\$0.00
Balance Due:	\$2,469.62

Approval: _____ Date: _____



October 14, 2020

**Bazetta Township Fire Department
3000 Warren Meadville Rd
Cortland, OH 44410**

Arrow Manufacturing Inc. hereby proposes to furnish to you, subject to your acceptance of this proposal the following vehicle and equipment in accordance with the attachments hereto:

\$139,900	New 2020 Chevy G4500 Type 3 Arrow Ambulance with a 6.0L V-8 Gasoline engine and including options as described and shown in photos in website listing #01070. Remounted and reconditioned including all applicable Lifetime Warranties (attached).
\$1,850	Install red/yellow reflective chevron striping on rear including rear doors
\$3,765	Allowance to Install custom printed vinyl to include department patches on cab doors, tri-color striping running entire length and department name and unit numbers
\$620	Install cab to body door
\$1,740	Install Whelen traffic advisor above rear doors
\$2,880	Allowance to install Ultra-Violet disinfecting light in patient compartment
\$150,755	TOTAL

FOB: Rock Rapids, IA

Approximate Completion: **2-3 weeks for installation of options.** after receipt of signed proposal and deposit. Completion is dependent on parts availability and any changes by customer after receipt of order. Ambulance chassis is subject to availability.

Terms: **(40%)** deposit with receipt of signed proposal. Remaining balance due upon pick up.

NOTE: Prices do not include any taxes, title, license, registration and inspection fees unless specifically stated in the attachments hereto.

Ambulance quoted is currently available, but is subject to prior sale.

Arrow Manufacturing Inc. reserves the right to withdraw or amend this proposal if not accepted on or before **November 30, 2020.** Please sign and fax/email back as your acceptance of this proposal.

Respectfully Submitted by:
ARROW MFG. INC.

Agreed and Accepted by:
BAZETTA TWP FIRE DEPARTMENT

(signature)

(signature)

(proposal date)

(acceptance date)

801 South East Street ~ P.O. Box 349
Rock Rapids, IA 51246
1-800-743-3157
FAX 712-472-3156
www.arrowmfginc.com ~ info@arrowmfginc.com

Specification Summary

Reference: QU0000001339 Rev: 0
 Purchaser: North Eastern Rescue Vehicles
 Contact: Bob Reilly
 Address: 10 Dwight Park Drive
 Syracuse, NY

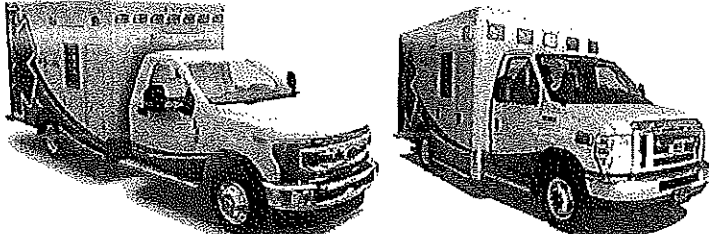
<i>Name</i>	<i>Specifications</i>
<p>CCL150</p> 	<ul style="list-style-type: none"> • Aluminum Extruded Body Construction • CrestCoat Powder Coating Technology • Aluminum Cabinets • Multiplex Electrical System • Flush Mount Windows • CrestClean Antimicrobial Coating

Sales Options by Category

Base

<i>Name/Description</i>	<i>Quantity</i>
TYPE I - CCL150	1.00
TYPE I - CCL150	
72in Interior Headroom	1.00
72in Interior Headroom	
KKK-A-1822F	1.00
KKK-A-1822F - USA Government Federal Specification for a Star-of-Life Ambulance	

Chassis

<i>Name/Description</i>	<i>Quantity</i>
Ford F350 chassis cab 4x4 diesel	1.00
Ford F350 Super Duty Diesel Chassis Cab 4x4	
Anti-theft	1.00
Anti-theft security system	
High Idle	1.00
High Idle system	

Ford OEM chassis mirrors	1.00
OEM chassis mirrors	
Running Boards	1.00
Diamond-plate aluminum running boards with grip strut	
Hidden front grille door unlock switch	1.00
Hidden front grille door unlock switch	

Drivers Compartment

Name/Description	Quantity
Manual adjustment seat	1.00
OEM manually adjustable chassis seats	
Talk-through with sliding window	1.00
Cab to module talk-through opening with sliding window	
Chassis voltmeter and conversion voltmeter	1.00
OEM chassis voltmeter, Digital conversion voltmeter on driver's console	
Patient status indicator lights	1.00
Patient status indicator lights (Red/Yellow/Green) on driver's console	
Ram mount console	1.00
Ram mount console	
Door indicator light	1.00
"Door ajar" and "Compartment" indicator light on driver's console	
Two USB charging outlets	1.00
Two USB charging outlets on driver's console	
No floor mount console	1.00
No floor mount console	
Passenger reading light	1.00
Ceiling mount red/white LED reading light centered over passenger seat	
Driver's reading light	1.00
One (1) additional ceiling mount red/white LED reading light centered over driver seat	

Conversion

Name/Description	Quantity
C1 Compartment, ALS Access and Battery Compartment	1.00
C1 Compartment - ALS inside/outside access with a sealed battery storage area	
Battery slide-out tray	1.00
Battery slide-out tray in C1 compartment	
C2 Side Entrance Door	1.00
C2 - Side entrance door with tinted flush mount window	
Dual step entry with step well light	1.00
Two-step interior access with LED step well light	
C3 Compartment, Equipment Storage	1.00
Open storage in C3 Compartment	
C3 - Backboard storage	1.00
Dual backboard storage with straps, two adjustable shelves for equipment bags, and stair chair storage in C3 Compartment	
S1 Compartment - Main Oxygen Storage	1.00
Main oxygen storage in S1 Compartment	
S2 Compartment - ECC	1.00
Electrical Control Center (ECC) with lower equipment storage in S2 Compartment	
ECC cover	1.00
Aluminum panel in ECC compartment to cover and protect electrical from water and debris	

S3 Compartment, Outside access closed off	1.00
Equipment storage with outside access closed off in S3 compartment	
50/50 Rear doors	1.00
50/50 Split rear entry doors with flush mounted tinted windows	
Black rubber fenderettes	1.00
Flexible black rubber fenderettes over rear wheels	
Rear kick plate with no text	1.00
Rear kick plate with no text	
Aluminum rub-rails on each side	1.00
Aluminum rub-rails on each side of conversion	
Undercoating protection	1.00
Undercoating protection	
Rear mudguard	1.00
Rear mudguard	
Rear bumper underbody	1.00
Rear bumper underbody	
Module front corner stone guard	1.00
Module front corner stone guard aluminum checker-plate protection	
Flush license plate with LED light	1.00
Flush license plate with LED light	

Exterior Lighting

<i>Name/Description</i>	<i>Quantity</i>
Clearance lights	1.00
Clearance lights - Seven amber and seven red LED marker lights	
Two 3/4 inch red LED mid-body side lights at rear	1.00
Two 3/4 inch red LED mid-body side lights at rear to be marker top with turn signal below	
Two red LED brake/tail lights	1.00
Two red LED brake/tail lights	
Two amber LED turn lights	1.00
Two amber LED turn lights	
Two white LED reverse lights	1.00
Two white LED reverse lights	

Emergency Systems

<i>Name/Description</i>	<i>Quantity</i>
Chrome bezels	24.00
Standard Series chrome bezels	
Colored lens	1.00
Emergency lights to have colored lenses	
Five Whelen 900-Series lights	1.00
Five Whelen 900-Series lights (Red / Red / White \ Red \ Red) on front of conversion	
Two Whelen 700-Series red lights, one each side	1.00
Two Whelen 700-Series red intersection lights, one each side of chassis	
Two Whelen LIN6 Series red lights	1.00
Two Whelen LIN6 Series red lights	
Four Whelen 900-Series red lights (two each side)	1.00
Four Whelen 900-Series red lights (two on each side of conversion)	
Four Whelen 900-series halogen scene lights	1.00
Four Whelen 900-series halogen scene lights (two on each side of conversion)	
Mid Body 700 Series above rear wheel	1.00
Two Whelen 700-Series red lights above rear wheel, one each side	

Two Whelen 900-Series and one 700-Series lights	1.00
Two Whelen 900-Series and one 700-Series lights (Red / Amber \ Red) on rear of conversion	
Two Whelen 600 series LED load lights	1.00
Two Whelen 600-Series LED load lights on rear of conversion	
Two Whelen 900-Series red lights at window height	1.00
Two Whelen 900-Series red lights at window height on rear of conversion	
Siren amplifiers (100 watt)	1.00
100 Watt Siren amplifier with 4 tones and public address (P/A) microphone	
Two siren speakers in front bumper	1.00
Two siren speakers in front bumper	

Interior Curbside Configuration

<i>Name/Description</i>	<i>Quantity</i>
Two (2) position squad bench, 6-point harness	1.00
Two position squad bench with 6-point harness system. Provides ability for second patient transport using backboard. Includes recessed waste and sharps container at head of squad bench.	
Squad safety net	1.00
Safety restraint net installed forward of curbside seating	
Curbside overhead aluminum cabinet	1.00
Overhead aluminum cabinet above curbside seating	
ALS Compartment	1.00
Front ALS compartment with two adjustable shelves	
Drug cabinet	1.00
Drug cabinet above ALS compartment	

Interior Streetside Configuration

<i>Name/Description</i>	<i>Quantity</i>
CPR seat with 6-point harness system	1.00
CPR seat with 6-point harness system	
Fixed frames	1.00
Fixed frames with sliding polycarbonate doors	
Aluminum countertop	1.00
Aluminum countertop : Powder coated with antimicrobial coating	

Attendant Seat

<i>Name/Description</i>	<i>Quantity</i>
Child safety device	1.00
Rear-facing EVS seamless vinyl seat with child safety device and 3-point seatbelt	
Box Base with front/rear slider	1.00
Box Base with front/rear slider	

Cot Configuration

<i>Name/Description</i>	<i>Quantity</i>
Stryker universal floor plate only	1.00
Stryker universal floor plate only	
Pre-wire Power-LOAD	1.00
Pre-wire Power-LOAD	
Center mount cot configuration	1.00
Center mount cot configuration	

Oxygen

<i>Name/Description</i>	<i>Quantity</i>
-------------------------	-----------------

Quick disconnect style outlet	1.00
Quick disconnect style outlet	
O2 to Go oxygen loading system	1.00
O2 to Go oxygen loading system with detachable ramp	
One oxygen outlet in Action Area	1.00
One oxygen outlet in Action Area	
One additional oxygen outlet in Action Area	1.00
One additional oxygen outlet in Action Area	
One oxygen outlet on curbside wall	1.00
One oxygen outlet on curbside wall	

Electrical

<i>Name/Description</i>	<i>Quantity</i>
Multiplex system	1.00
Multiplex electrical system using toggle switches with LED backlit pictogram	
Curbside switch panel	1.00
Curbside switch panel	
Rear speaker volume control	1.00
Rear speaker volume control at Action Area	
Temperature control with automatic setting	1.00
Temperature control with automatic setting at Action Area	
Patient status indicator lights	1.00
Patient status indicator lights (Red/Yellow/Green) at Action Area	
On/off LED reading light	1.00
On/off LED reading light above Action Area	
Four antenna ports with pre-wiring	1.00
Four antenna ports with pre-wiring for antenna RG 58 A/U	
Two OEM batteries	1.00
Two OEM batteries	
Additional 3rd battery	1.00
Additional 3rd battery	
Back up alarm	1.00
Back-up alarm (97db)	
High intensity LED compartment rope lights	1.00
High intensity LED compartment rope lights	
Six LED dome lights	1.00
Six LED dome lights with multiple intensity settings	
Xantrex Freedom XC pure sine-wave inverter/charger	1.00
Xantrex Freedom XC pure sine-wave inverter/charger	
Auto Eject - Yellow 20 amps	1.00
Auto-eject shoreline outlet - 120V 20 amp assembly with a yellow waterproof cover	
Shoreline light	1.00
Indicator light above the shoreline plug to show power connection	
1 120V GFCI outlet In Action Area	1.00
One Hospital-grade 120 VAC GFCI dual outlet with indicator light in Action Area	
1 120V outlet in lower ALS area	1.00
One Hospital-grade 120 VAC dual outlet with indicator light in lower ALS area	
1 120V outlet in upper ALS area	1.00
One Hospital-grade 120 VAC dual outlet with indicator light in upper ALS area	
One 12 VDC outlet in lower ALS area	1.00
One 12 VDC outlet in lower ALS area	

One 12-VDC outlet in Action area	1.00
One 12-VDC outlet in Action area	
Camera monitor in cab	1.00
Camera monitor in cab	
Back-up camera	1.00
Back-up camera	
Rico RS4X disposable suction system	1.00
Rico RS4X disposable suction system in Action Area	

HVAC

<i>Name/Description</i>	<i>Quantity</i>
Combo heat and AC	1.00
Combo heat and air conditioning with exhaust fan for contaminated air	
Front mounted condenser	1.00
Front mounted condenser	

Accessories

<i>Name/Description</i>	<i>Quantity</i>
Three glove box holder above side entry door	1.00
Three glove box holder above side entry door	
Recessed digital clock above rear entry doors	1.00
Digital clock recessed above rear entry doors	
No fire extinguisher in chassis	1.00
No fire extinguisher in chassis cab	
No fire extinguisher in S3 compartment	1.00
No fire extinguisher in S3 compartment	
L-shaped yellow grab bar on side entry door	1.00
L-shaped yellow grab bar on side entry door	
L-shaped yellow grab bars on rear entry doors	1.00
L-shaped yellow grab bars on rear entry doors	
One 61in ceiling mounted grab rail	1.00
One 61in ceiling mounted yellow grab rail	
Technimount monitor mounting base	1.00
Technimount monitor mounting base located in Action Area	
Four clip style IV hangers with strap	1.00
Four clip style IV hangers with strap (2 curbside wall, 2 streetside wall)	
Spare plastic trash liners	1.00
Twelve spare plastic trash liners	

Finish and Trim

<i>Name/Description</i>	<i>Quantity</i>
Interior powdercoated white	1.00
Cabinets, wall panels and ceiling are white anti-microbial powder coated aluminum	
Black upholstery	1.00
Black vinyl upholstery with yellow head bolster pads on entry doors	
Floor : Slip resistant, rolled-up 5 in. (127mm)	1.00
Floor : Slip resistant, rolled-up 5 in. (127mm)	
Lonplate II Midnight #443TXM	1.00
Lonplate II Midnight #443TXM flooring	
Clear anti-slip spray	1.00
Clear anti-slip spray applied to side entry steps	

Paint and Graphics

<i>Name/Description</i>	<i>Quantity</i>
-------------------------	-----------------

CRESTLINE

Powdercoat module white

1.00

Powdercoat entire module white to match the chassis

ALL WARNING, SCENE, AND TAIL LIGHTS TO HAVE CHROME BEZELS.
 ALL COMPARTMENT/ENTRY DOORS TO HAVE POWER LOCKS
 WIRE TO OEM

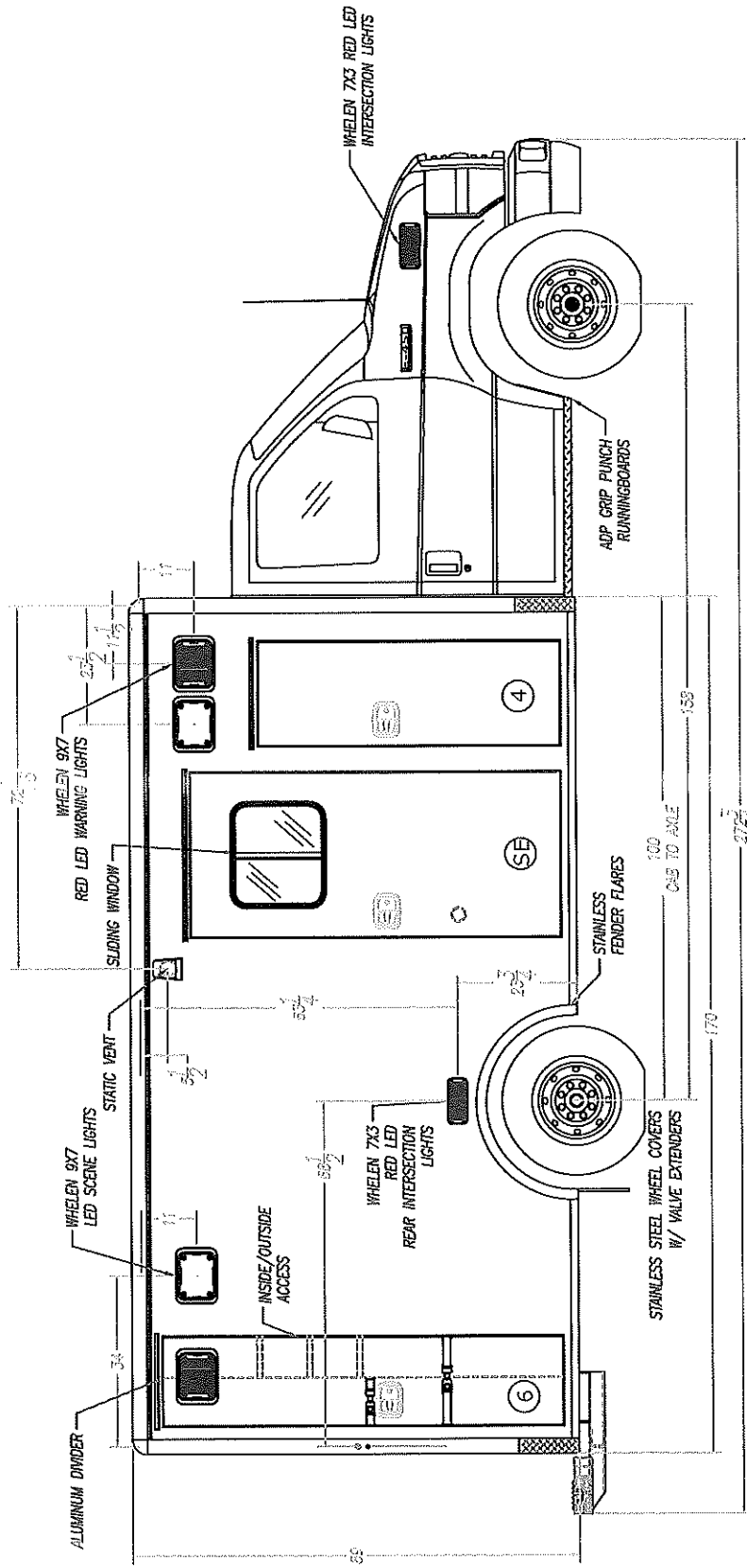

COMPARTMENT SIZES		NOTE: THE DIMENSIONS BELOW ARE INSIDE TUB DIMENSIONS	
NO.	COMPARTMENT TYPE	WIDTH	HEIGHT
4	ALS COMPARTMENT	20 1/2"	14 1/2"
5	BATTERY COMPARTMENT	20"	79 1/2"
6	BACK BOARD COMPARTMENT	20"	22"

COMPARTMENT / ENTRY DOOR SIZES		WIDTH	HEIGHT
4	ALS DOOR	20 1/2"	60 1/8"
5	BATTERY STORAGE DOOR	32 1/2"	73 3/8"
SE	SIDE ENTRY DOOR	17 1/2"	79 3/8"
6	BACK BOARD STORAGE DOOR	17 1/2"	79 3/8"

COMPARTMENT & ENTRY DOORS		NO.	PART NUMBER
4	ALS COMPARTMENT	6	33-A10783
5	BATTERY COMPARTMENT	5	33-A10784
SE	SIDE ENTRY DOOR	6	33-A10786

COMPARTMENT TUBS		NO.	PART NUMBER
5	ALS COMPARTMENT	5	33-100692
6	BATTERY COMPARTMENT	6	33-103025

COMPARTMENT / ENTRY DOOR TYPE		SCALE:
4	ALS DOOR	5/16" = 1'
5	BATTERY STORAGE DOOR	5/16" = 1'
SE	SIDE ENTRY DOOR	5/16" = 1'
6	BACK BOARD STORAGE DOOR	5/16" = 1'

COMPARTMENT / ENTRY DOOR TYPE		DATE CREATED:	DATE REVISED:
4	ALS DOOR	5/11/20	---
5	BATTERY STORAGE DOOR	5/11/20	---
SE	SIDE ENTRY DOOR	5/11/20	---
6	BACK BOARD STORAGE DOOR	5/11/20	---

COMPARTMENT / ENTRY DOOR TYPE		DESCRIPTION:
4	ALS DOOR	M2 170" TYPE III
5	BATTERY STORAGE DOOR	FORD E-450 158" WHEELBASE
SE	SIDE ENTRY DOOR	CURB SIDE EXTERIOR
6	BACK BOARD STORAGE DOOR	CURB SIDE EXTERIOR

COMPARTMENT / ENTRY DOOR TYPE		NO.	PART NUMBER
4	ALS DOOR	6	33-A10783
5	BATTERY STORAGE DOOR	5	33-A10784
SE	SIDE ENTRY DOOR	6	33-A10786

COMPARTMENT / ENTRY DOOR TYPE		NO.	PART NUMBER
5	ALS COMPARTMENT	5	33-100692
6	BATTERY COMPARTMENT	6	33-103025

3008 MOBILE DRIVE
 ELKHART, IN 46514
 PH: 574-266-0911
 SPECIALTY VEHICLES, INC. FAX: 574-266-6669
MEDIX
 "LET US SHOW YOU THE MEDIX DIFFERENCE"
 WWW.MEDIXAMBULANCE.COM

Note: Drawings are for reference only, measurements may vary from actual product.

ALL WARNING, SCENE, AND TAIL LIGHTS TO HAVE CHROME BEZELS.
 ALL COMPARTMENT/ENTRY DOORS TO HAVE POWER LOCKS
 WIRE TO OEM

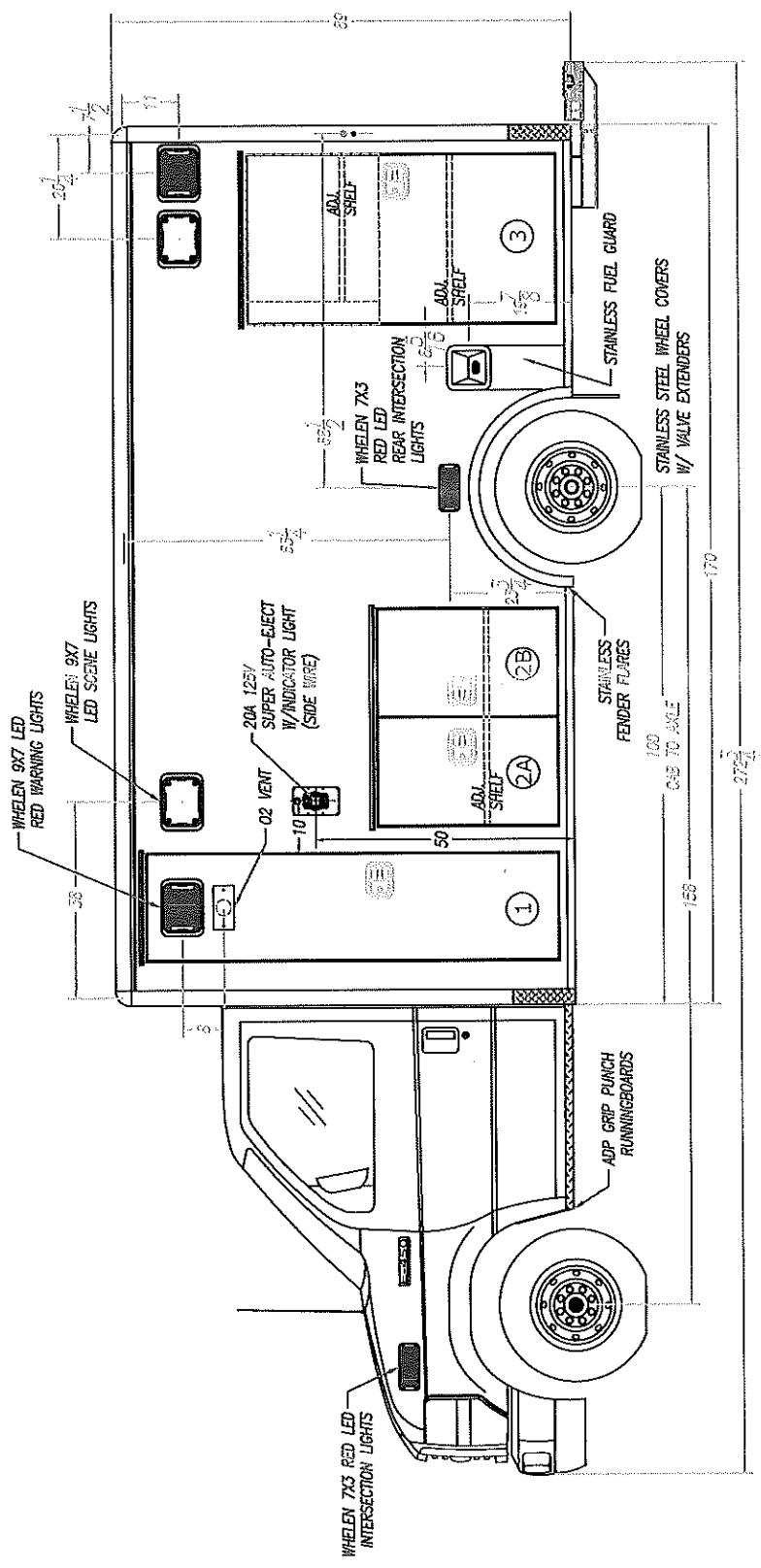

COMPARTMENT SIZES		NOTE: THE DIMENSIONS BELOW ARE INSIDE TUB DIMENSIONS		
NO.	COMPARTMENT TYPE	WIDTH	HEIGHT	DEPTH
1	O2 COMPARTMENT	20 1/2"	79 1/2"	18 1/2"
2	MID STORAGE COMPARTMENT	41 1/2"	34 1/2"	18 1/2"
3	REAR STORAGE COMPARTMENT	34"	59 1/2"	19 1/4"

COMPARTMENT / ENTRY DOOR SIZES		WIDTH	HEIGHT
1	COMPARTMENT / ENTRY DOOR TYPE	20 1/2"	79 1/2"
2A	O2 STORAGE DOOR	20 1/2"	34 1/2"
2B	MID STORAGE DOOR-A	20 1/2"	34 1/2"
3	MID STORAGE DOOR-B	20 1/2"	34 1/2"
	REAR STORAGE DOOR	32 1/2"	59 3/4"

COMPARTMENT & ENTRY DOORS		NO.	PART NUMBER
1	NO.	33-A10780	
2A/B	NO.	33-A10781	
3	NO.	33-A10782	

COMPARTMENT TUBS		NO.	PART NUMBER	NO.	PART NUMBER
1	NO.	33-100689			
2	NO.	33-103079			
3	NO.	33-103439			

COMPARTMENT / ENTRY DOOR SIZES		DATE CREATED:	SCALE:
FORD E-450 158" WHEELBASE		5/11/20	5/16"=1'
STREET SIDE EXTERIOR		DATE REVISED:	REVISION:
SDG			

MEDIX
 SPECIALTY VEHICLES, INC. 3008 MOBILE DRIVE
 ELKHART, IN 46514
 PH: 574-266-0911
 FAX: 574-266-6669
 "LET US SHOW YOU THE MEDIX DIFFERENCE"
 WWW.MEDIXAMBULANCE.COM

ALL WARNING, SCENE, AND TAIL LIGHTS TO HAVE CHROME BEZELS.
 ALL COMPARTMENT/ENTRY DOORS TO HAVE POWER LOCKS
 WIRE TO OEM

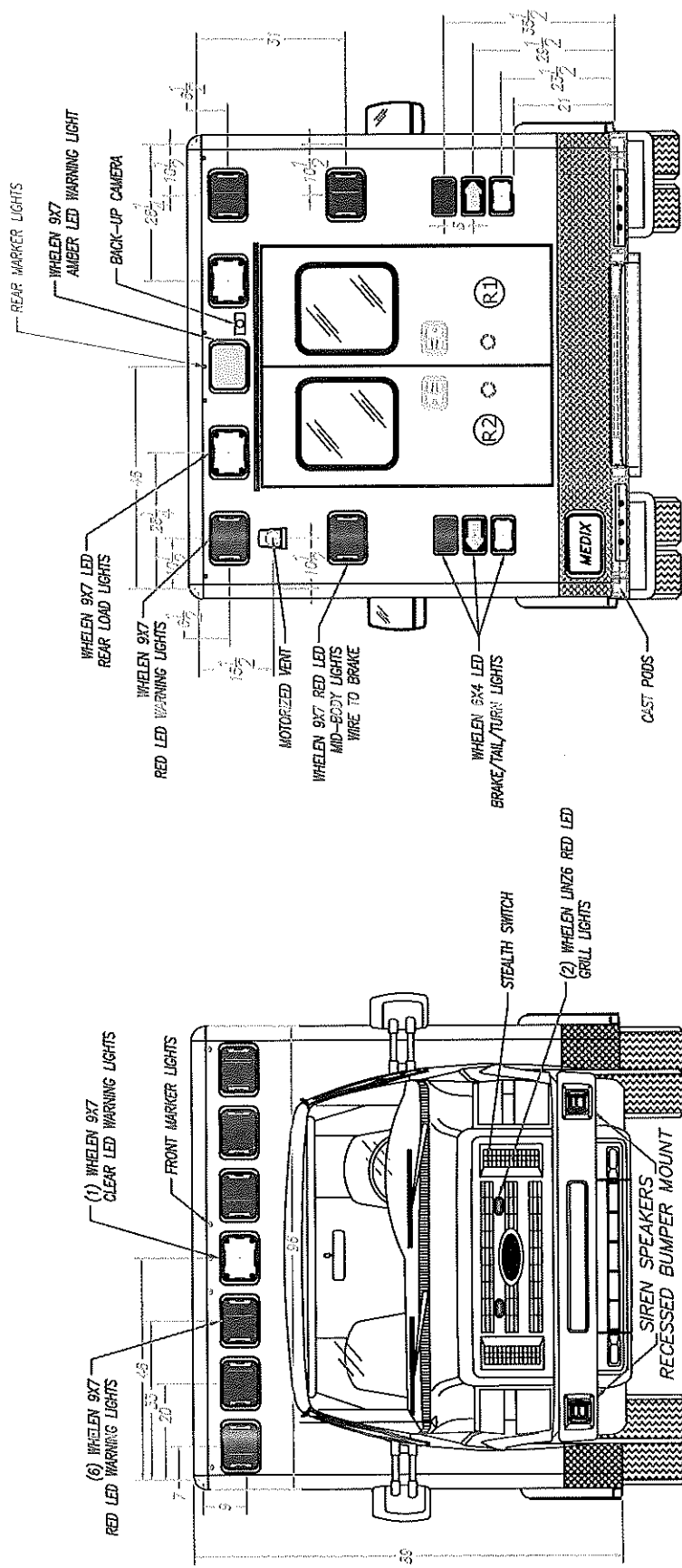

MEDIX
 3008 MOBILE DRIVE
 ELKHART, IN 46514
 PH: 574-266-0911
 SPECIALTY VEHICLES, INC. FAX: 574-266-6669
 "LET US SHOW YOU THE MEDIX DIFFERENCE"
 WWW.MEDIXAMBULANCE.COM

M2 170" TYPE III
 FORD E-450 158" WHEELBASE

DESCRIPTION:	FRONT & REAR EXTERIOR
DRAWN BY:	SDG
DATE CREATED:	5/11/20
DATE REVISED:	
SCALE:	5/16" = 1'
REVISION:	

Note: Drawings are for reference only, measurements may vary from actual product.

REAR ENTRY DOOR SIZES		PART NUMBER
NO.	WIDTH	HEIGHT
R1	24 3/8"	60"
R2	24 3/8"	60"

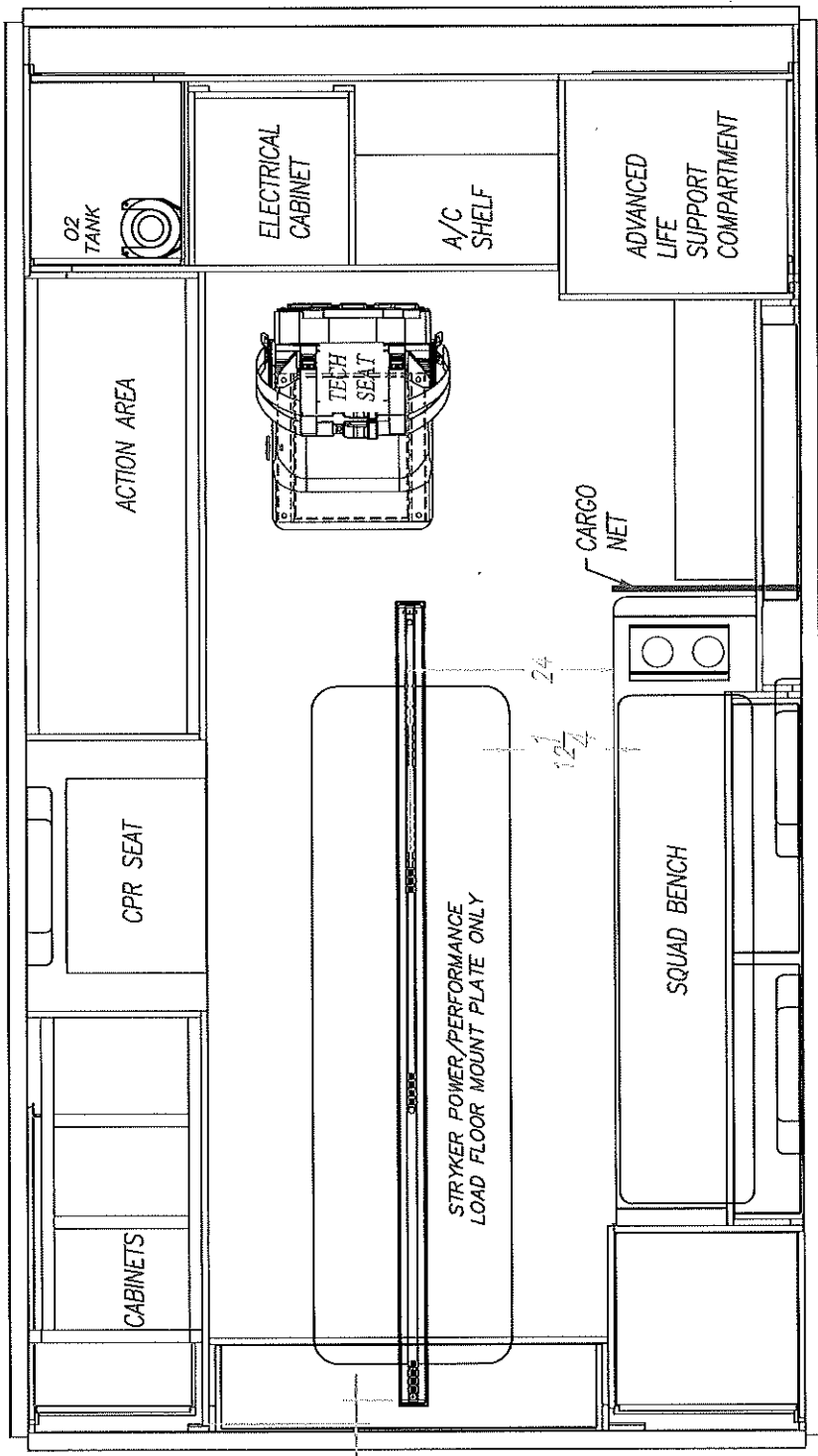

MEDIX
 SPECIALTY VEHICLES, INC.
 3008 MOBILE DRIVE
 ELKHART, IN 46514
 PH: 574-266-0911
 FAX: 574-266-6669
 "LET US SHOW YOU THE MEDIX DIFFERENCE"
 WWW.MEDIXAMBULANCE.COM

M2 170" TYPE III FORD E-450 158" WHEELBASE	
DESCRIPTION:	PATIENT AREA PLAN
DRAWN BY:	DATE CREATED:
SDG	5/11/20
REVISIONS:	SCALE:
DATE REVISED:	1/2"=1'
REVISION:	---

Note: Drawings are for reference only, measurements may vary from actual product.

CORIAN COUNTERTOPS IN 1ST & 2ND ACTION AREA.

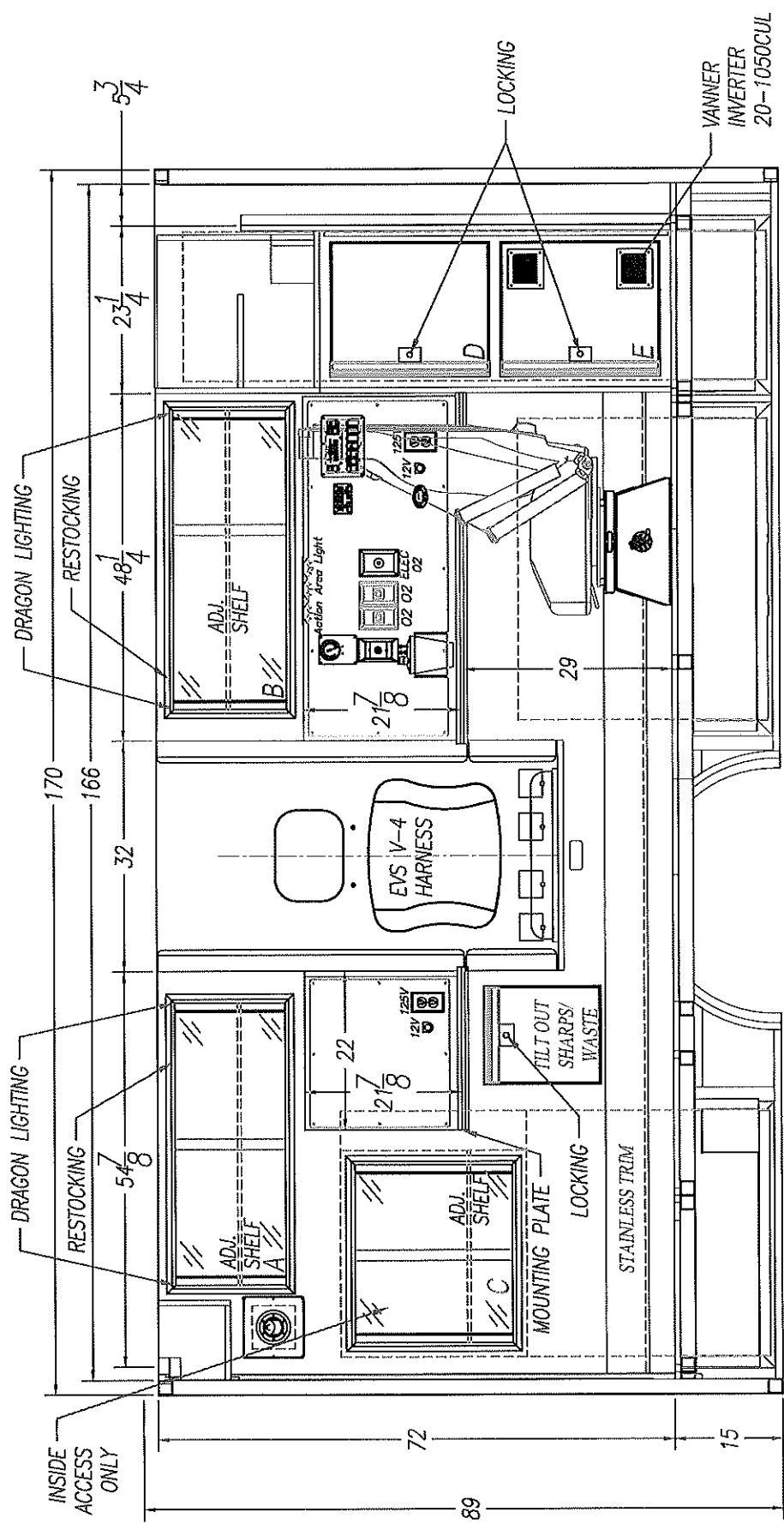

INTERIOR CABINET STORAGE			
ITEM	HEIGHT	WIDTH	DEPTH
A	19 1/2"	22 1/4"	18"
B	16 3/4"	34 1/2"	18"
C	22 1/4"	25 1/4"	6"
D	23 1/2"	21 3/4"	17 1/2"
E	23 3/4"	21 3/4"	17 3/4"
F	-	-	-

M2 170" TYPE III	
FORD E-450 158" WHEELBASE	
DESCRIPTION:	STREET SIDE INTERIOR
DRAWN BY:	SDG
DATE CREATED:	5/11/20
SCALE:	1/2"=1'
REVISION:	-
DATE REVISED:	-

Note: Drawings are for reference only, measurements may vary from actual product.

MEDIX
 SPECIALTY VEHICLES, INC.
 3008 MOBILE DRIVE
 ELKHART, IN 46514
 PH: 574-266-0911
 FAX: 574-266-6669
 WWW.MEDIXAMBULANCE.COM
 "LET US SHOW YOU THE MEDIX DIFFERENCE"

Dealer: PENNCARE

Approved By:

Date:

Customer: DEMO

20-M299

She

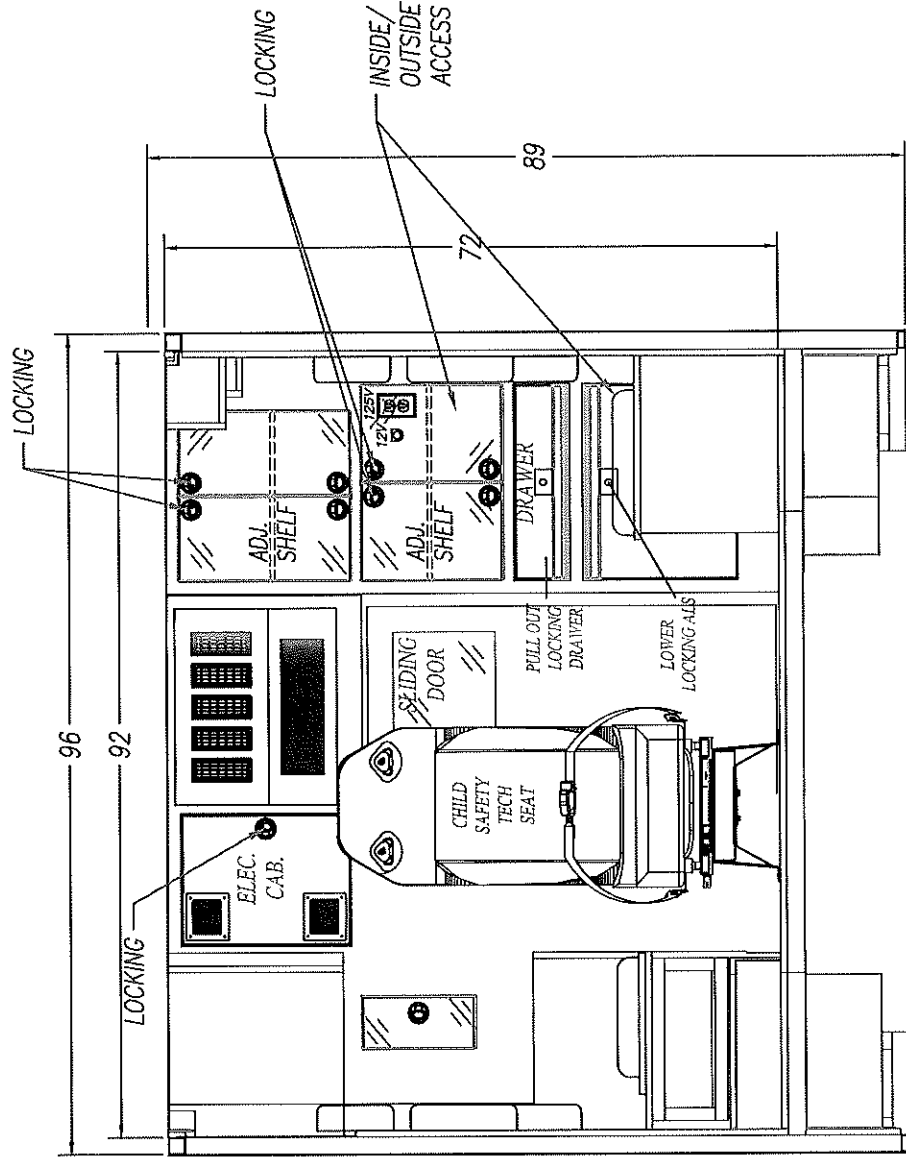

M2 170" TYPE III	
FORD E-450 158" WHEELBASE	
DESCRIPTION:	FRONT ELEVATION
DRAWN BY:	SDG
DATE CREATED:	5/11/20
DATE REVISED:	
SCALE:	1/2" = 1'
REVISION:	

Note: Drawings are for reference only, measurements may vary from actual product.

MEDIX
 SPECIALTY VEHICLES, INC.
 3008 MOBILE DRIVE
 ELKHART, IN 46514
 PH: 574-266-0911
 FAX: 574-266-6669
 "LET US SHOW YOU THE MEDIX DIFFERENCE"
 WWW.MEDIXAMBULANCE.COM

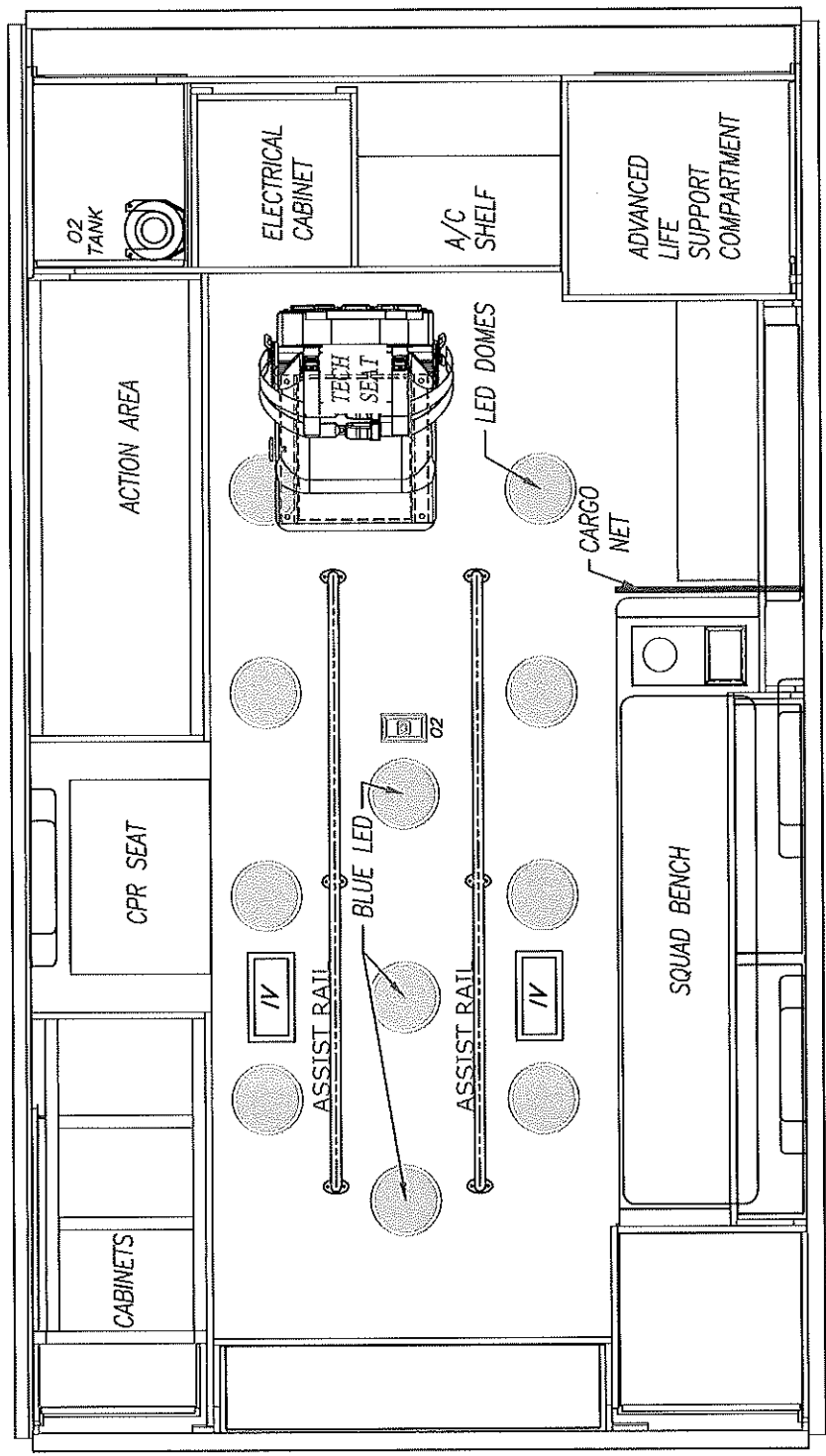

MEDIX
 3008 MOBILE DRIVE
 ELKHART, IN 46514
 PH: 574-266-0911
 SPECIALTY VEHICLES, INC. FAX: 574-266-6669
 "LET US SHOW YOU THE MEDIX DIFFERENCE"
 WWW.MEDIXAMBULANCE.COM

M2 170" TYPE III	
FORD E-450 158" WHEELBASE	
DESCRIPTION: CEILING LAYOUT	
DRAWN BY: SDG	DATE CREATED: 5/11/20
REVISIONS:	SCALE: 1/2" = 1'
DATE REVISED:	REVISION:

Note: Drawings are for reference only, measurements may vary from actual product.

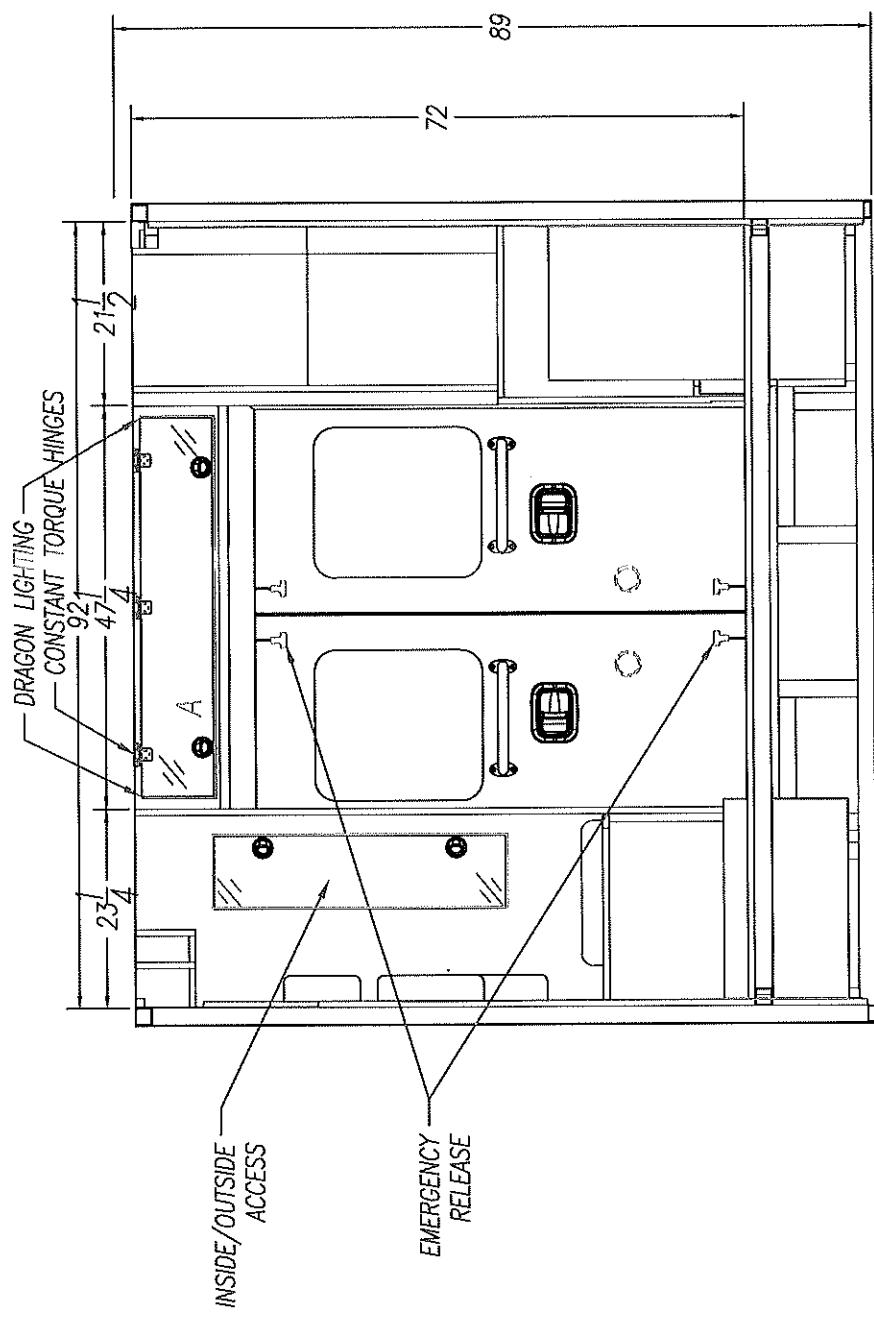

MEDIX
 SPECIALTY VEHICLES, INC.
 3008 MOBILE DRIVE
 ELKHART, IN 46514
 PH: 574-266-0911
 FAX: 574-266-6669
 "LET US SHOW YOU THE MEDIX DIFFERENCE"
 WWW.MEDIXAMBULANCE.COM

M2 170" TYPE III	
FORD E-450 158" WHEELBASE	
DESCRIPTION:	REAR ELEVATION
DRAWN BY: SDG	DATE CREATED: 5/11/20
REVISIONS:	SCALE: 1/2" = 1'
DATE REVISED:	REVISION:

ITEM	HEIGHT	WIDTH	DEPTH	SPECIAL NOTE
A	7"	44 1/4"	9"	
B				
C				
D				
E				
F				

Note: Drawings are for reference only; measurements may vary from actual product.

BAZETTA TWP. FIRE/EMS

Chief's Office

INTEROFFICE MEMORANDUM

Date: 10/15/2020

To: Trustee McBride, Trustee Parke, Trustee Webb,

From: Chief Dennis Lewis

Re: October 15, 2020 Trustee's Emergency Meeting

Trustee McBride – Trustee Parke – Trustee Webb,

Agenda items: **For Administration**

Agenda items: **For Fire Department**

1. Requesting approval to purchase 2021 Ford E 450 Medix MSV II Demo Ambulance M299 for \$149,463 from Penn Care, Inc, 1317 North Road, Niles, Ohio 44446. The NECESSARY expenditure incurred due to the public health emergency with respect to COVID-19 and \$130,463 will be paid from Fund 2272-519 with remaining \$19,000 coming from the Fire Department Budget. If any Cares Act Funds are unencumbered by November 15, 2020 those funds will be encumbered up to the \$19,000.00 back to the fire department budget for the purchase of the Ambulance.
 - a. Three Quotes Attached
 - b. State Term Contract attached
 - i. Note: Cash Price for Ambulance \$154,263.00 with \$4,800 in savings. See Quote for details.

Non agenda items:

Professionally,
Dennis Lewis
Fire Chief



Emergency Vehicle Purchase Agreement
October 15, 2020

Purchaser:
Bazetta Fire Department
3000 Warren Meadville Rd
Cortland, OH 44410

Seller:
Penn Care, Inc.
1317 North Rd.
Niles OH 44446

Penn Care, Inc. sells to Purchaser a 2021 Ford E450 Medix MSV II Demo Ambulance M299, as designed per the attached specifications, and when applicable, technical drawings, graphic design and other required documents. Additions, deletions and/or changes must be approved by all parties in writing and may cause delays in deliveries and additional charges to the purchaser.

PRICING

2021 Ford E450 Medix MSV II Demo Ambulance M299	\$140,498.00
2021 Options added to base	\$4,765.00
2021 Chassis MY increase	\$2,000.00
2021 Ford FIN GPC Rebate	-\$4,800.00
2021 Graphics Package (Beltline, chevrons, lettering, decals)	\$4,800.00
Code 3 Vital Vio UV Disinfecting Lights (4 total w/ switch/install)	\$2,200.00
Opticom pre-wire only	\$0.00
Universal MDT Mount	\$0.00

Ambulance Total **\$149,463.00**

Priced in accordance with Ohio STS #233, Contract #800389

TRADE DESCRIPTION: N/A

TRADE-IN TERMS AND APPRAISAL

Where Purchaser wishes to trade-in a used motor vehicle as part of the consideration for the motor vehicle ordered, Seller may appraise the trade-in at the time of the execution of this order by Purchaser. Seller also reserves the right to reappraise the trade-in at the time of delivery. The seller shall not alter a Trade-In appraisal from the time of the initial appraisal until the time of delivery unless:

- 1) Intervening factors indicate an apparent decrease in the value of the value of the trade-in over and above ordinary wear and tear
- 2) A change occurs in the mechanical performance of the vehicle
- 3) Emergency, medical, and/or other equipment/components have been removed that were not previously discussed and agreed to in writing
- 4) The Seller has made any misrepresentation of the vehicle and/or components to Penn Care, Inc.

DELIVERY TIMES

Penn Care shall deliver the completed ambulance to customer prior to Dec. 11th, 2020



WARRANTY

No representation has been made by Penn Care, Inc., except as herein stated and no warranties, expressed or implied, may arise except from this writing. All warranties are issued by the chassis manufacturer, the ambulance builder, and/or component parts suppliers and Penn Care, Inc. shall have no liability with respect to warranties issued by the chassis manufacturer, the ambulance builder, and component parts suppliers. Used vehicles are "as is" and have no warranty.

INVOICING AND PAYMENT

Unless otherwise agreed to in writing, Penn Care, Inc. will invoice the Purchaser 30 days prior to the scheduled delivery date. Upon completion of production and quality inspection by the Purchaser the vehicle is declared ready for delivery and payment will be due upon acceptance and/or delivery.

PAYMENT OF SALES AND USE TAXES

The price for the motor vehicle specified in this agreement does not include Sales Taxes and Use Taxes (Federal, State, or Local) unless expressly stated. Purchaser assumes and agrees to pay, unless prohibited by law, and such Sales, Use, or Occupational Taxes imposed on or applicable to the transaction covered by this agreement, regardless of which party may have primary tax liability.

ACCEPTANCE

When requesting a final inspection the Purchaser shall inspect the vehicle(s) within 10-days of notification of completion of production. Vehicles not inspected by buyer will be deemed complete and ready for delivery, and payment will be due upon delivery. Items and issues discovered after the 10-day window shall not hold up payment from buyer to Penn Care Inc., these issues will be handled as warranty claims following the normal procedures.

PAYMENT AND TITLE

All payments shall be made in U.S. dollars either by certified check or wire transfers, credit card payments are not acceptable without prior written authorization (fees will apply). Payment terms are COD, unless otherwise agreed to in writing by Penn Care, Inc. Interest terms begin 16-days from date of delivery and are charged at a rate of prime plus 6%. MSO and title are released to Purchaser upon payment in full, including any related interest, shipping expenses, and other related costs and expenses to Penn Care Inc. or to the appointed floor plan financing company.

As collateral security for the payment of the purchase price of the Vehicles, Buyer hereby grants to Penn Care Inc., a lien on and security interest in and to all of the right, title, and interest of Purchaser in, to, and under the Vehicles, wherever located, and whether now existing or hereafter arising or acquired from time to time, and in all accessions thereto and replacements or modifications thereof, as well as all proceeds, including insurance proceeds, of the foregoing. The security interest granted under this provision constitutes a purchase money security interest under the Ohio Uniform Commercial Code.

CANCELLATION

Penn Care, Inc., may, in its sole discretion, and without liability or penalty, cancel this order if Penn Care, Inc. determines that Purchaser (i) fails to pay any amount due under these Terms and Conditions, (ii) has not otherwise performed or complied with any of these Terms and Conditions, in whole or in part, or (iii) becomes insolvent, files a petition for bankruptcy, or commences or has commenced against it proceedings relating to bankruptcy, receivership, reorganization, or assignment for the benefit of creditors. Penn Care's election to cancel Purchaser's order under such circumstances is in addition to, and not in lieu of, any other rights or remedies that Penn Care, Inc. may have at either law or equity or under the Terms and Conditions of this Agreement.

Penn Care's manufactures commence engineering, no cancellation of this order is permitted, and the full purchase price is due and payable to Penn Care, Inc. Notwithstanding other provisions of this Agreement, and in addition thereto, Penn Care, Inc. shall be entitled to its reasonable and anticipated lost profit from such cancellation.

FORCE MAJEURE

Penn Care, Inc. shall not be liable or responsible to Purchaser, nor be deemed to have defaulted or breached these Terms and Conditions, for any failure or delay in fulfilling or performing any of these Terms and Conditions when and to the extent such failure or delay is caused by or results from acts or circumstances beyond the reasonable control of Penn Care, Inc., and/or the manufactures which Penn Care, Inc. represents including, without limitation, acts of God, flood, fire, earthquake, explosion, governmental actions, war, invasion or hostilities, terrorist threats or acts, riot or other civil unrest, national emergency, revolution, insurrection, epidemic, lockouts, strikes or other labor disputes (whether or not relating to either party's workforce), restraints or delays affecting carriers, inability or delay in obtaining supplies of adequate or suitable materials, or telecommunication breakdown, or power outage.

DEFAULT/ATTORNEY'S FEES

Purchaser is in default of the Terms and Conditions if any of the following occurs (except as prohibited by law): (i) Purchaser fails to perform any obligation that Purchaser has undertaken in these Terms and Conditions; or (ii) Penn Care, Inc., in good faith, believes that Purchaser cannot, or will not, pay or perform the obligations it has agreed to in the Terms and Conditions.



If Purchaser defaults, or in the event Penn Care, Inc. brings an action or proceeding to enforce the terms hereof or declare rights hereunder, Purchaser agrees to pay Penn Care, Inc. costs for collecting amounts owing, including, without limitation, court costs, attorney's fees (for attorneys who are not our salaried employees), and fees for repossession, repair, storage, and sale of Vehicles, all without relief from valuation and appraisal laws.

GOVERNING LAW

All of terms and provisions of the agreement and the rights and obligations of the parties hereto shall be interpreted and enforced in accordance with the laws of the State of Ohio.

REMEDIES

If Purchaser is in default of these Terms and Conditions, Penn Care, Inc. shall have all the remedies provided by law in these Terms and Conditions: (i) Penn Care, Inc. may require Purchaser to immediately pay Penn Care, Inc., subject to any refund required by law, the remaining unpaid balance due; (ii) Penn Care, Inc. may require Purchaser to make the Vehicle available to Penn Care, Inc. at a designated place that is reasonably convenient to each party; (iii) Penn Care, Inc. may immediately take possession of the Vehicle by legal process or self-help, but in doing so Penn Care, Inc. may not breach the peace or unlawfully enter onto Purchaser's premises; (iv) Penn Care, Inc. may then sell the Vehicle and apply what it receives as provided by law to Penn Care, Inc. reasonable expenses and then toward Purchaser's obligations; and (v) Except when prohibited by law, Penn Care, Inc. may sue Purchaser for additional amounts if the proceeds of a sale do not pay all of the amounts Purchaser owes to Penn Care, Inc. By choosing any one or more of these remedies, Penn Care, Inc. does not waive its right to use another remedy. By deciding not to use any remedy, Penn Care, Inc. does not give up its right to consider the event a default if it happens again.

PURCHASER

Signature: _____

Name/Title: Fire Chief

Date: 10/15/2020